

Printable Mounting Template for use with 8in(203mm) CTC Appliance Pull

Read all instructions prior to installing.

Questions? Contact Amerock customer service at 800-435-6959.

Amerock is not responsible for incorrect drilling or damage to mounting surface.

Visit Amerock.com to download and print 12in(305mm) and 18in(457mm) CTC Appliance Pull templates.

Items Required

- Pencil
- Level
- Ruler
- 3/16in Drill Bit
- Drill

STEP 1: Printing This Template

1a. Print both pages at 100% scale on letter-sized (8.5in x 11in) paper. **Do not scale to fit.**

1b. Once complete, check the 8in center-to-center (CTC) distance with a ruler to ensure it measures exactly 8in.

STEP 2: Using This Template

2a. Once you have printed and checked this template, decide where you want to mount your appliance pull. In the following steps, you will draw a centerline and tick mark on the cabinet or drawer surface to help you align this template and mark drill holes.

2b. Use a level and pencil to lightly draw a straight centerline on the cabinet or drawer surface (refer to Figure 1 or 2 on Page 2). This centerline will indicate the orientation and placement of the appliance pull.

2c. Next, make a tick mark on your drawn centerline to indicate where you would like the middle point of the appliance pull (refer to Figure 1 or 2 on Page 2).

2d. Align the top edge of this template with your drawn centerline on the cabinet or drawer, and be sure Template Centerline is aligned with the tick mark you drew in Step 2c.

2e. Holding the template in place, tape it to the cabinet or drawer. Using the 8in CTC line above as a guide, lightly mark on drawn centerline the two points where you will need to drill (refer to Figure 3 on Page 2).

2f. Before drilling, remove template and use level to re-check that the drawn centerline is properly aligned with the cabinet or drawer. If not, erase all marks and repeat Steps 2b-2f. You are now ready to proceed with drilling and installation.

Figure 1
Drawing centerline and tick mark
for vertical mounting

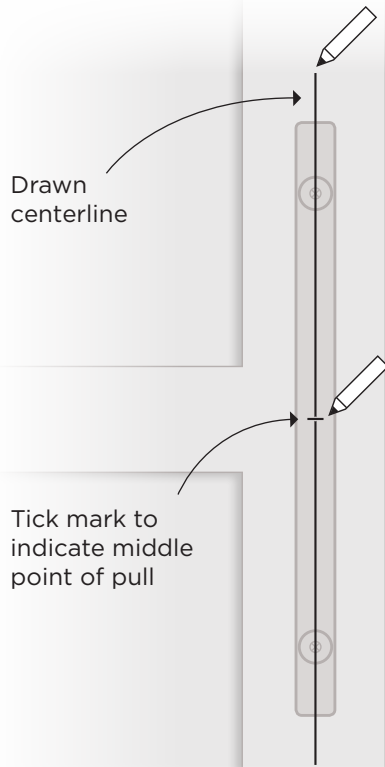

Figure 2
Drawing centerline and tick mark for horizontal mounting

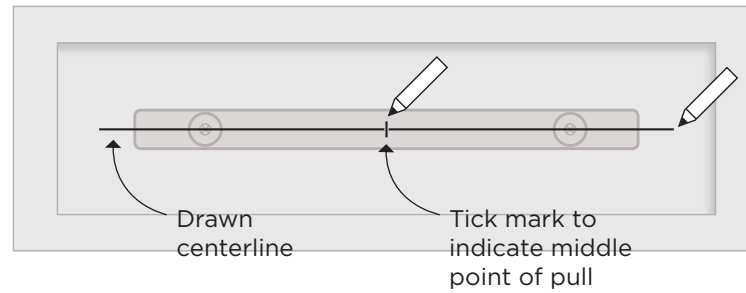

Figure 3
Marking drill holes on drawn centerline

